



13 Rosina Avenue Harrington Park, NSW



## Family home on expansive 624sqm block

Set in a peaceful locale, this generous dual level residence is spread over an expansive 624sqm block. With a family friendly layout consisting of various formal and casual areas, this home is tastefully presented with neutral colour tones. Embraced by light filled interiors offering a residence of enormous and serene appeal.

- Well positioned in a family friendly locale
- Broad selection of formal and casual living spaces
- Stunning granite kitchen with 900mm gas oven and walk-in pantry
- Four spacious bedrooms upstairs, fifth bedroom downstairs
- Deluxe master suite with walk-in robe and twin shower ensuite
- Remote double garage, with drive through access to one
- Media room complimented with projector and wide screen
- Oversized covered alfresco area for year round entertaining
- Sparkling in-ground fresh water solar heated swimming pool
- Conveniently positioned close to schools, shops and parks

For more details please visit

<https://staging.gyproperty.com.au/5367674>



**Luke Mannion**

0428 473 629

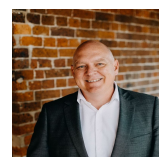

**Luke Mannion**

0428 473 629



GROUND FLOOR

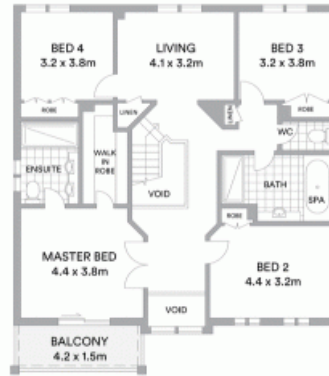

FIRST FLOOR



**McGrath**

Scale in metres. Indicative only. All information contained herein is obtained from sources we believe to be accurate. We cannot guarantee its accuracy. Interested persons should make and rely on their own enquiries

13 Rosina Avenue, Harrington Park, NSW

